



For Use With PC113-2C (2 Pole) Relay

FEATURES

- Pressure Clamp Screws
- Two Hold Down Cups Included
- Heat Stabilized Thermoplastic
- RoHS Compliant

Socket Without Finger Safe Terminals

Dimensions in mm

Socket With Finger Safe Terminals

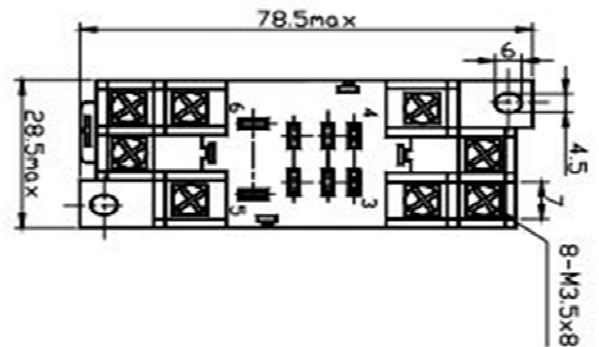
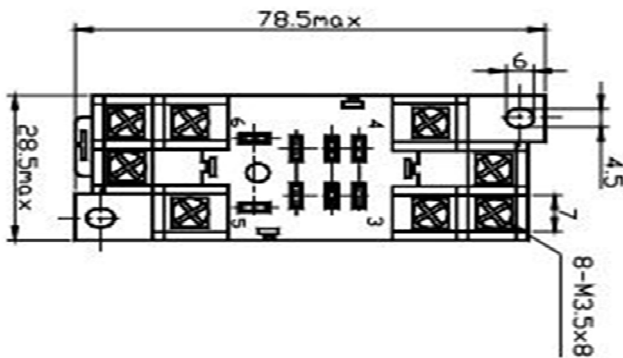
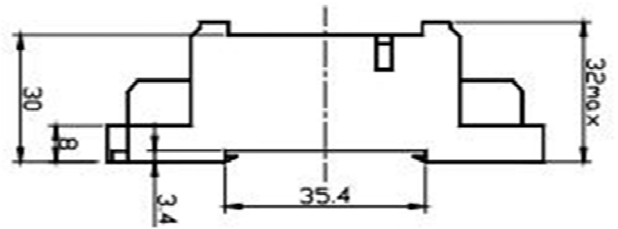
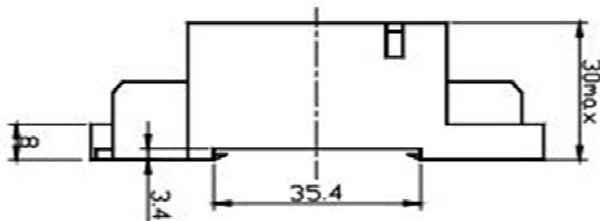

Notes

All Picker Components sockets have pressure clamp screws
 Fits standard 35mm Din Rail
 Tolerances +/- 0.010 unless otherwise noted

NOTES 1).Dimensions are in millimeters.

2).Inch equivalents are given for general information only.

ORDERING INFORMATION

Part Number	Description	Terminals
SC113-2C-F1	8 Pin Socket	Open Terminal
SC113-2C-F2	8 Pin Socket	Finger Safe

Hold Down Clip

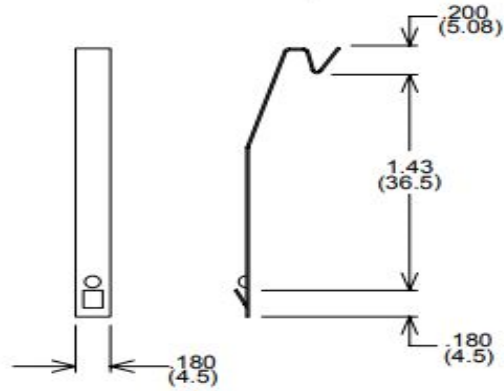

Terminal Layout Top View

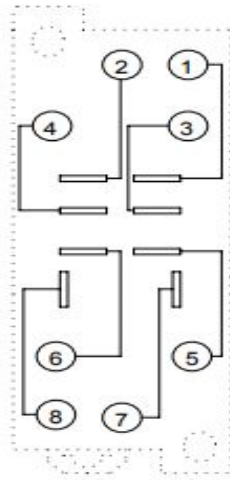

Mounting Dimensions Top View

